



PREMIER ESTATES

CLUB VILLAS
AT
DUBAI HILLS



LIFE IN THE SPIRIT
OF ABSOLUTE LUXURY





DESIGN THAT EMBODIES
MODERN SIMPLICITY AND
SOPHISTICATION









SPECTACULAR VIEWS AND OPEN SPACES



Your new home will offer scenic views of the golfcourse and also a rooftop terrace to entertain friends and loved ones.

A COMMUNITY LIFESTYLE FOR FAMILIES TO FLOURISH



The nearby community centre comprises of a swimming pool as well a playground, allowing residents to enjoy time out with their families.

LUSH FAIRWAYS NESTLED BETWEEN GREEN EXPANSES

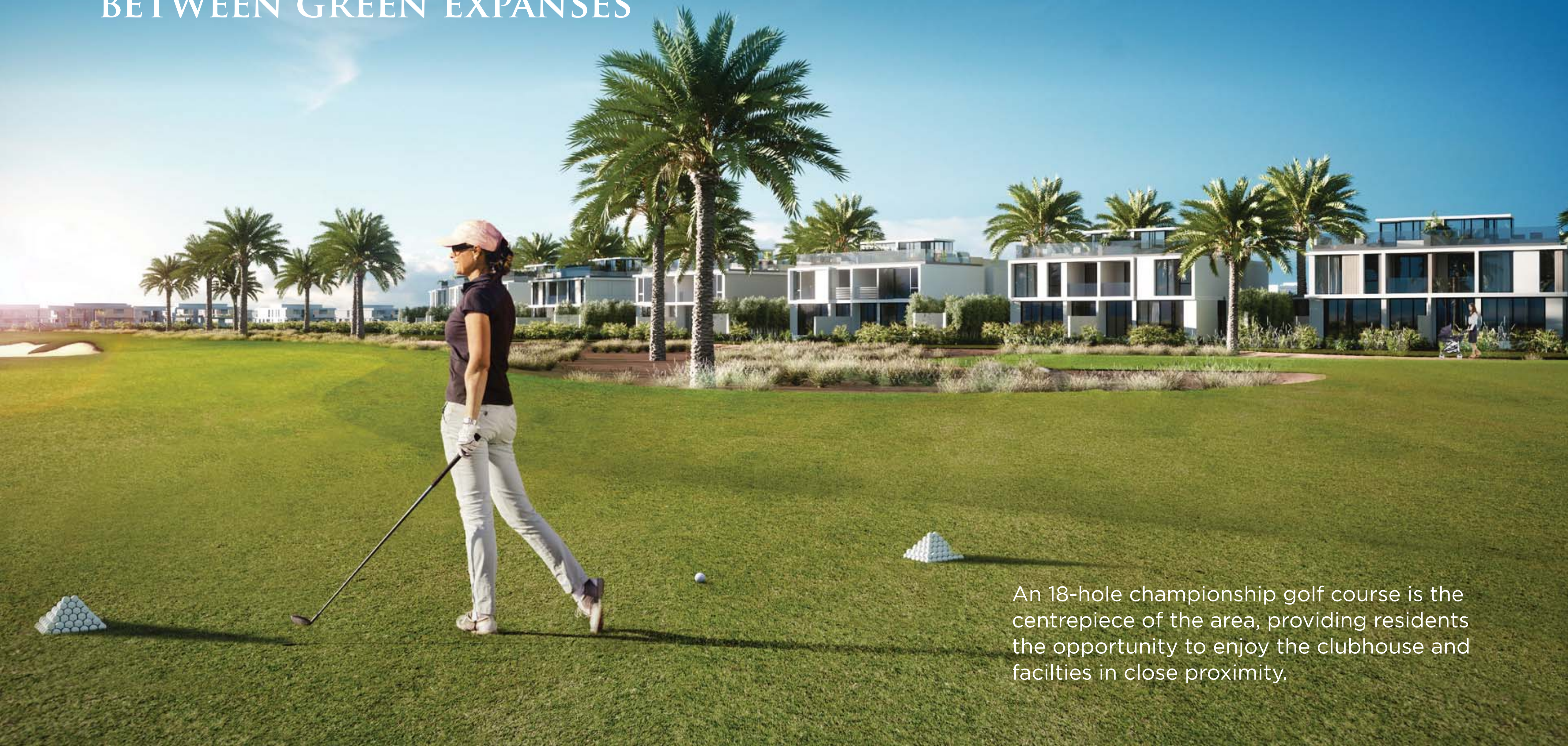

An 18-hole championship golf course is the centrepiece of the area, providing residents the opportunity to enjoy the clubhouse and facilities in close proximity.



MAKE CLUB VILLAS
AT DUBAI HILLS
YOUR NEW HOME

The Club Villa designs are driven by contemporary architecture, elegantly defined by clean lines and splashes of rich materiality in a seamless manner.

VILLA STYLES

Designed with 5 unique aesthetic styles, choose between 3 and 4 bedroom villas which suit your taste.



MODERN



INTERNATIONAL



MINIMALIST



CUBIC



CONTEMPORARY

CLUB VILLAS AT DUBAI HILLS



SITE PLAN

- MODERN
- INTERNATIONAL
- MINIMALIST
- CUBIC
- CONTEMPORARY

THB - 4 BEDROOM

THA - 3 BEDROOM

SA-A - 3BR STANDALONE UNITS

SA-B - 4BR STANDALONE UNITS

CLUB VILLAS
AT
DUBAI HILLS

FLOOR PLANS



EMAAR



MERAAS

CLUB VILLAS AT DUBAI HILLS

DUBAI HILLS ESTATE

3 BEDROOM

	Total BUA	
	Sqm	Sqft
International - TH01	272.40	2932.09
International - TH02	271.99	2927.67
Contemporary - TH01	271.84	2926.06
Contemporary - TH02	271.72	2924.77



TH01 TH02



Ground Floor



First Floor



Roof Terrace

FLOOR PLAN 1. All dimensions are in imperial and metric, and measured from finish to finish excluding construction tolerances. 2. All materials, dimensions, and drawings are approximate only. 3. Information is subject to change without notice, at developer's absolute discretion. 4. Actual area may vary from the stated area. 5. Drawings not to scale. 6. All images used are for illustrative purposes only and do not represent the actual size, features, specifications, fittings, and furnishings. 7. The developer reserves the right to make revisions / alterations, at its absolute discretion, without any liability whatsoever.



EMAAR



MERAAS

CLUB VILLAS AT DUBAI HILLS

DUBAI HILLS ESTATE

3 BEDROOM

	Total BUA	
	Sqm	Sqft
Modern - TH01	271.96	2927.35
Modern - TH02	271.96	2927.35
Minimalist - TH01	271.85	2926.17
Minimalist - TH02	271.82	2925.84
Cubic - TH01	272.71	2935.42
Cubic - TH02	272.72	2935.53



TH01 TH02



Ground Floor



First Floor



Roof Terrace

FLOOR PLAN 1. All dimensions are in imperial and metric, and measured from finish to finish excluding construction tolerances. 2. All materials, dimensions, and drawings are approximate only. 3. Information is subject to change without notice, at developer's absolute discretion. 4. Actual area may vary from the stated area. 5. Drawings not to scale. 6. All images used are for illustrative purposes only and do not represent the actual size, features, specifications, fittings, and furnishings. 7. The developer reserves the right to make revisions / alterations, at its absolute discretion, without any liability whatsoever.



EMAAR



MERAAS

CLUB VILLAS AT DUBAI HILLS

DUBAI HILLS ESTATE

4 BEDROOM

	Total BUA	
	Sqm	Sqft
Modern - TH01	312.47	3363.40
Modern - TH02	312.83	3367.27
International - TH01	312.28	3361.35
International - TH02	312.76	3366.52
Minimalist - TH01	312.21	3360.60
Minimalist - TH02	312.76	3366.52
Cubic - TH01	312.29	3361.46
Cubic - TH02	312.69	3365.76
Contemporary - TH01	312.29	3361.46
Contemporary - TH02	312.67	3365.55

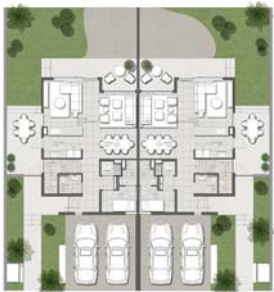

TH01 TH02



Ground Floor



First Floor



Roof Terrace

FLOOR PLAN 1. All dimensions are in imperial and metric, and measured from finish to finish excluding construction tolerances. 2. All materials, dimensions, and drawings are approximate only. 3. Information is subject to change without notice, at developer's absolute discretion. 4. Actual area may vary from the stated area. 5. Drawings not to scale. 6. All images used are for illustrative purposes only and do not represent the actual size, features, specifications, fittings, and furnishings. 7. The developer reserves the right to make revisions / alterations, at its absolute discretion, without any liability whatsoever.



EMAAR



MERAAS

CLUB VILLAS AT DUBAI HILLS

DUBAI HILLS ESTATE

3 BEDROOM STANDALONE

	Total BUA	
	Sqm	Sqft
Modern - TH01	277.56	2987.63



Ground Floor



First Floor



Roof Terrace

FLOOR PLAN 1. All dimensions are in imperial and metric, and measured from finish to finish excluding construction tolerances. 2. All materials, dimensions, and drawings are approximate only. 3. Information is subject to change without notice, at developer's absolute discretion. 4. Actual area may vary from the stated area. 5. Drawings not to scale. 6. All images used are for illustrative purposes only and do not represent the actual size, features, specifications, fittings, and furnishings. 7. The developer reserves the right to make revisions / alterations, at it's absolute discretion, without any liability whatsoever.



EMAAR



MERAAS

CLUB VILLAS AT DUBAI HILLS

DUBAI HILLS ESTATE

4 BEDROOM STANDALONE

	Total BUA	
	Sqm	Sqft
Modern - TH02	321.16	3456.93



Ground Floor



First Floor



Roof Terrace

FLOOR PLAN 1. All dimensions are in imperial and metric, and measured from finish to finish excluding construction tolerances. 2. All materials, dimensions, and drawings are approximate only. 3. Information is subject to change without notice, at developer's absolute discretion. 4. Actual area may vary from the stated area. 5. Drawings not to scale. 6. All images used are for illustrative purposes only and do not represent the actual size, features, specifications, fittings, and furnishings. 7. The developer reserves the right to make revisions / alterations, at its absolute discretion, without any liability whatsoever.



EMAAR



MERAAS

CLUB VILLAS AT DUBAI HILLS



DUBAI HILLS ESTATE

1st Installment
5%
Purchase Date

2nd Installment
10%
30 Apr 2018

3rd Installment
10%
20 Jan 2019

40% Construction Completion
10%
30 Sep 2019*

60% Construction Completion
10%
30 Jan 2020*

80% Construction Completion
10%
30 May 2020*

100% Construction Completion
45%
31 Oct 2020*

* Estimated construction completion date

Project No: 1992



EMAAR



MERAAS



PREMIER ESTATES

Premier Estates, P03 Building 2, Bay Square, Business Bay, Dubai - UAE, ORN : 11814
Phone: +971 4 425 2780 Fax: +971 4 425 2601 Email: info@dubaipremierestates.com

www.dubaipremierestates.com